

Types of delivery and packing Extruded and drawn products



Types of delivery and packing

The choice of delivery and packaging type allows the co-ordination of transport, storage and processing options across a wide range.

Products in straight lengths

We offer seven standard packing types which are optimised according to the products. Each package has a label on the

front side with all data required to identify the product/order. Variations to the selection shown can be arranged.

Types of packaging conditions for products in straight lengths



Wooden case for round rods < 10 mm
Wooden case for sections/tubes
Stackable: approx. 500 kg, approx. 3 m

Z011
Z012



Bundle of round rods ≥ 10 mm
Bundle of sections/tubes
Weight: 1000 kg (500 kg)

Z021
Z022



Returnable wooden case for rods
Weight: approx. 1000 kg
Returnable wooden case for tubes

Z031
Z032



Pallet with cardboard for sections/tubes in short lengths
Weight: max. 500 kg
Z092



Cardboard for sections/tubes with interleaving foil

Z040

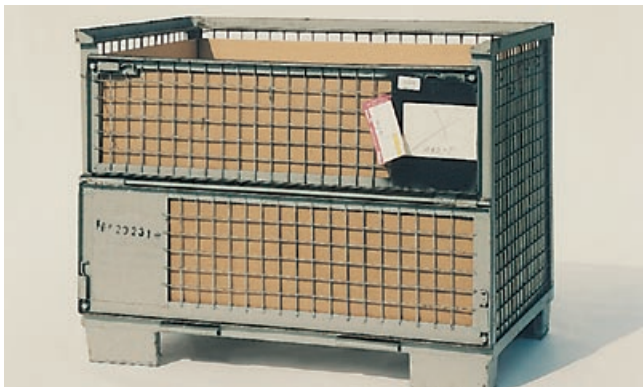

Skeleton box for sections/tubes in short lengths
Weight: max. 800 kg

Z112

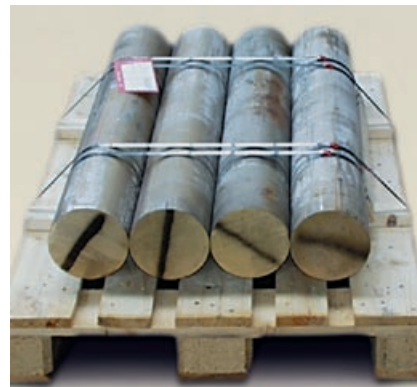

Billets on wooden pallet

Z150

Products in coils (wires)

Whilst only the weight of the packaging unit must be specified for straight lengths, more detailed information is necessary for wires.

- Type of winding
- Position of section in coil (for sectional wires)
- Packaging type

When delivery and packaging type are not specified on an enquiry/order, we choose the best combination based on our experience.

However, the winding type is not freely available for all cross sections. Please see the limits in the table on page 4.

Coil design		
<input type="checkbox"/> Level-wound	<input checked="" type="checkbox"/> Bunched/coiled	<input type="checkbox"/> Cardboard drum
<input type="checkbox"/> Without cardboard core	<input type="checkbox"/> Cardboard core	<input checked="" type="checkbox"/> Uncoiling device
<input type="checkbox"/> Clockwise	<input checked="" type="checkbox"/> Anti-clockwise	<input type="checkbox"/> Wooden reel
<input type="checkbox"/> Position/position	<input type="checkbox"/> Cross-wound	<input type="checkbox"/> Plastic reel
Coil weight: <u>500 kg</u>	Coil ID: _____	Coil OD: <u>400 mm</u>
Show position of sectional wire in drawing		Coil width: <u>600 mm</u>

Picture 1: Example of a checklist

Type of winding

We distinguish between two types of winding:

- **bunched/rolled**, in this case, all windings have more or less identical diameters. The standard uncoiling direction is anti-clockwise.

Bunched/rolled coils can be delivered in the following types:

- bunched
- in cardboard drum (only anti-clockwise)
- on uncoiling device (only anti-clockwise)

- **Level-wound**, In this form, windings with the same diameter are placed next to each other, and wound up, layer by layer, with an increasing winding diameter. Turning the coil by 180° will change the uncoiling direction. The type of layering (position/position or cross-wound) depends on the product and is usually specified by the manufacturer. Wires that are cross-wound can usually be uncoiled more easily. Any changes may be agreed upon request.

Level-wound coils can be delivered in the following types:

- without cardboard core
- with cardboard core
- on wooden reel, on cardboard reel



bunched coil



position/position



cross-wound

Type of winding	Uncoiling direction	Cross section of wires		905000/ Coil dimension		Max. coil weight (Coil width)
		Round, square and hexagonal wires (ø or hex in mm)	Sectional wires (Weight/m in kg/m) partly limited due to shape	Inner diameter in mm	Outer diameter in mm	
Bunched/coiled, in coils		1.5– 2.0	0.015–0.027	ca. 400	ca. 550	25 kg
		2.1– 3.0	0.028–0.060	ca. 400	ca. 600	50 kg
		3.1– 4.5	0.061–0.107	ca. 400	ca. 650	80 kg
		4.6– 5.5	0.108–0.202	ca. 500	ca. 700	100 kg
		5.6–13.0	0.203–1.128	ca. 550	ca. 900	250 kg
Bunched/rolled, in cardboard drum	Anti-clockwise	1.5– 3.0 (4.5)*	–	400	600	220 kg (small drum) 400 kg (large drum)
		Round only!				
Bunched/coiled, on uncoiling device		1.5– 3.0 (4.5)*	–	400	600	500 kg
		Round only!				
Level-wound, without cardboard core	Selectable	1.5– 4.0	0.015–0.082	400	800	250 kg (300 mm)
		4.1–10.0	0.083–0.667**	500/600/700	900	700 kg (200–500 mm)
		4.1–10.0	0.083–0.667**	500	1000	1000 kg (max. 500 mm)
Level wound, with cardboard core	Selectable	1.5– 4.0	0.015–0.082	400	800	250 kg (300 mm)
		4.1–10.0	0.083–0.667**	500/600/700	900	700 kg (300 mm)
		4.1–10.0	0.083–0.667**	500	1000	1000 kg (450 mm)

Type of winding	Uncoiling direction	Cross-section		Dimensions				Filling weight
		Ø in mm	Section	Flange Ø in mm	Core Ø in mm	Bore Ø in mm	Reel width in mm	
On reel	Optional	0.3–4.0	On request	355	224	36	200	50 kg
				500	315	36	250	100 kg
				560	360	127	460	250 kg
				630	360	127	500	500 kg
				800	400	127	555	1000 kg

* Dimensions > 3 mm require special designs for the uncoiling process of coils delivered in drums or uncoiling devices

** Larger dimensions and weight/m can be provided on request

Position of cross-section in coil

For asymmetrical types (e.g. sections), the position of the cross-section in the coil is determined by the possibilities and limits during the manufacturing process, and by the input direction of the machine on the finishing belt.

The position of the section in the coil must be specified. The picture on the right demonstrates one option. Asymmetric cross-sections are usually specified in a drawing. We therefore recommend the following illustration:

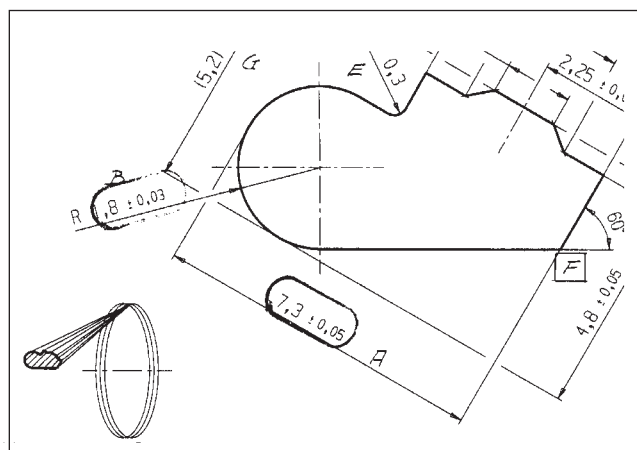

Illustration of the position of the section in the coil (Cut-out of drawing)

Types of delivery and packing

The recommendations for packing depend on the agreed layering type and can be adapted to the customer's storage and processing options. Each package has a label on the front

side with all data required to identify the product/order. The packages shown are recommendations only and changes may be agreed accordingly.

Packaging types for bunched/coiled wires



Pallet with cardboard for coils (in horizontal position)
Weight: max. 500 kg

Z091



Uncoiling device for wire in coils
On pallet 80 x 80 cm, fixed with steel strap
Total height: 112 cm

Z140



Cardboard drum
Bundled wire, drum with cover,
Outer-Ø x core-Ø x height = 600 x 400 x 550
Pallet 75 x 75 cm

Z130

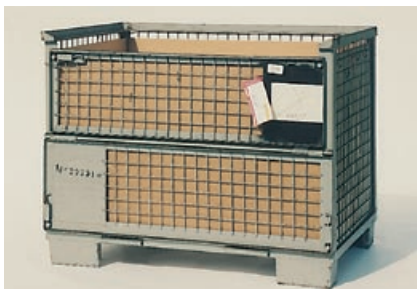

Skeleton box for coils with interleaving cardboard (in vertical/horizontal position)
box lined with cardboard
Weight: max. 800 kg

Z111



Wooden case for coils (in horizontal position), coils with interleaving cardboard, frame with cover.
Height: max. 70 cm
Weight: max. 800 kg

Z100



Pallet for coils vertical
Pallet with wooden wedges
Height: max. 120 cm
Weight: max. 1,000 kg

Z081

Packaging types for level-wound coils



Pallet for level-wound wire (in horizontal position) without cardboard core / on cardboard core, fixed with 4 steel straps. Weight: max. 1000 kg

Z060

Re-usable packing

With the environment and the reduction of disposal costs in mind, most Wieland products are packed in re-usable packaging. These particularly stable designs offer optimum protection against transportation damage and offer ease of handling. These are supplied to you or returned to us free of charge upon request. All re-usable packaging is labelled as follows

Wieland

Leihverpackung bitte zurücksenden
Packing to be returned
Emballage consigné à retourner

Wieland-Werke AG

www.wieland.com

Extruded and Drawn Products Division

Graf-Arco-Strasse 36, 89079 Ulm, Germany, Phone +49 (0)731 944-0, Fax +49 (0)731 944-2772, info@wieland.de

This leaflet is general information only and is not covered by an updating service. We are not liable for the correctness of its contents unless there is evidence of intent or gross negligence. Product characteristics are not assured. These pages do not replace individual advice or customers' in-house monitoring.



0541-03 101006.1Sc.02.001-1P-G